



**TRAXDA**  
Lift Kits - Made in USA

**Toll free: 888-660-5892**  
**email: info@traxda.com**

**SAFETY WARNING!**  
Always use the correct tools, and wear safety goggles. We **STRONGLY** recommend installation by a licensed mechanic on a properly secured locking lift.

#### TIRE FITMENT ADVICE

The best way to ensure proper tire fitment is to install the kit before purchasing your wheels and tires. Always test fit tires and wheels before purchasing.

#### VEHICLE RIDE WARNING!

Trucks with lift or level kits installed have a higher center of gravity. Aggressive and sudden direction changes may cause a tip over.

### 405045 Chevrolet/GM 8-Lug Lift and Level Kit

This kit contains:

- 2 - Torsion Keys
- 4 - Shock Spacer's
- 2 - Hardware Pack
- 2 - Rear Blocks
- 4- U-bolts
- Instructions
- Warranty Card
- Stickers



### Installation Tips

**Always use caution handling ABS or wheel sensor wiring. Avoid tension of any kind on wiring harness as this may cause damage or failure.**

1. Trucks are often not level side to side from the factory. Please measure before installation.
2. Re-torque all hardware to manufactures specifications
3. When aligning, to get the best tire wear use our supplied specifications. OEM specifications are for trucks with stock wheels and tires. Larger tires will wear differently.
4. All instructions are written with vehicle on a 2-post lift with tires removed.

## Step 1

Remove front shocks. Remove torsion key adjusting bolt. Using a tool similar to a torsion bar release tool (a c-clamp type ball joint press will work), apply pressure to the torsion key so the keeper nut in the cross member can be removed. Release pressure from torsion key and slide torsion bar forward allowing key to be removed.

## Step 2

Install **TRAXDA** torsion key. Using torsion bar tool, apply pressure to torsion key and install keeper and adjusting bolt. **IMPORTANT: the torsion bar must extend completely through key at least 1/4".**

## Step 3

Reinstall front shocks with supplied spacers on upper mouting studs. Secure in place using supplied nuts.

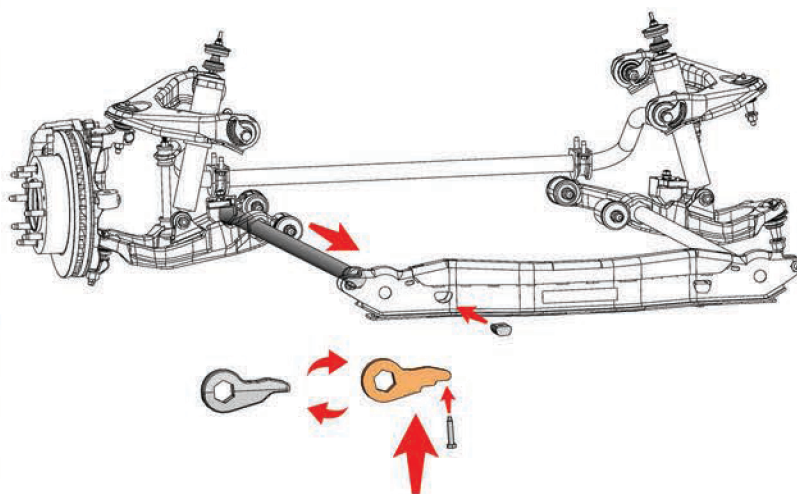

**Figure A:** Illustration is for reference only. Part dimensions will vary from kit to kit.

	Left	Right
Caster (degrees)	3	3.5
Camber (degrees)	0	-1/4 or -.25
Toe	1/16 or .0625 inch toe in	
Special Tools	none	

#### Alignment notes:

We recommend that a technician with experience doing alignments on lifted trucks perform the alignment. Large tires wear differently than OEM sized tires. Always do an alignment after changing tires on a vehicle.



**TRAXDA**  
Lift Kits - Made in USA

**Toll free: 888-660-5892**  
**email: info@traxda.com**

**SAFETY WARNING!**  
Always use the correct tools, and wear safety goggles. We **STRONGLY** recommend installation by a licensed mechanic on a properly secured locking lift.

**TIRE FITMENT ADVICE**

The best way to ensure proper tire fitment is to install the kit before purchasing your wheels and tires. Always test fit tires and wheels before purchasing.

**VEHICLE RIDE WARNING!**

Trucks with lift or level kits installed have a higher center of gravity. Aggressive and sudden direction changes may cause a tip over.

## 405045 Installation Instructions continued

### Rear Installation

Disconnect any ABS or other wires so they can droop. Loosen lower shock bolt and remove. Use a jack to support the differential. Remove U-bolts from one side of the truck only, this will help keep the differential steady. Using C-clamps, as shown below, secure leaf springs and remove centering pin. Install **TRAXDA** lock using the centering pin provided. Install supplied U-bolts, Re-connect lower shock. Repeat installation procedure on the other side of the truck.

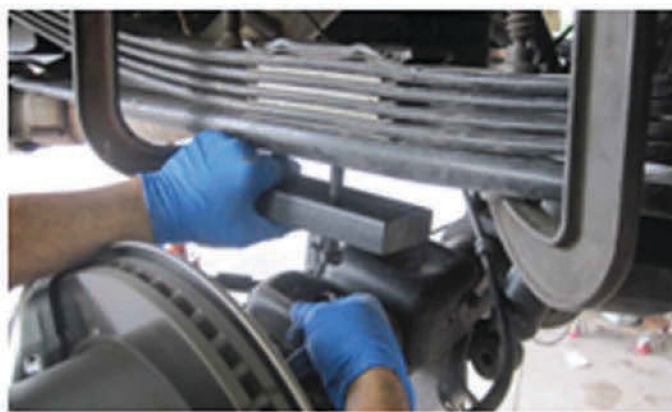

**Torque U-bolt hardware to 75 ft. lbs.**  
**Never reuse U-bolts**

**Alignment notes:**

We recommend that a technician with experience doing alignments on lifted trucks perform the alignment. Large tires wear differently than OEM sized tires. Always do an alignment after changing tires on a vehicle.

	Left	Right
Caster (degrees)	2	2.5
Camber (degrees)	0	-1/4 or -.25
Toe	1/32 or .03125 inch toe in	
Special Tools	none	