



**TRAXDA**  
Lift Kits - Made in USA

**Toll free: 888-660-5892**  
**email: info@traxda.com**

**SAFETY WARNING!**  
Always use the correct tools, and wear safety goggles. We **STRONGLY** recommend installation by a licensed mechanic on a properly secured locking lift.

#### TIRE FITMENT ADVICE

The best way to ensure proper tire fitment is to install the kit before purchasing your wheels and tires. Always test fit tires and wheels before purchasing.

#### VEHICLE RIDE WARNING!

Trucks with lift or level kits installed have a higher center of gravity. Aggressive and sudden direction changes may cause a tip over.

**101050** Lift and Level Kit: Ford Ranger 4x4, Mazda 3000/4000 4x4

This kit contains:

- 2- Torsion Keys
- 2 - Shock spacers

Instructions  
Warranty card  
Stickers



#### Installation Tips

**Always use caution handling ABS or wheel sensor wiring. Avoid tension of any kind on wiring harness as this may cause damage or failure.**

1. Trucks are often not level side to side from the factory. Please measure before installation.
2. Re-torque all hardware to manufactures specifications
3. When aligning, to get the best tire wear use our supplied specifications. OEM specifications are for trucks with stock wheels and tires. Larger tires will wear differently.
4. All instructions are written with vehicle on a 2-post lift with tires removed.

### Step 1

Remove Torsion Adjuster bolt completely. Remove key cover. Support lower control arm with pit jack. Loosen and remove upper ball joint nut, sway bar nut and remove shock A hammer may be needed to break the ball joint free.

### Step 2

Release tension on torsion bar by lowering pit jack and allowing lower control arm to swing down. With all the tension removed from the stock key, slide the torsion bar forward and remove the torsion key and keeper. Install **TRAXDA** part and stock key keeper. Refer to Figure A.

**Important! make sure the torsion bar is extended through the key by 1/4".**

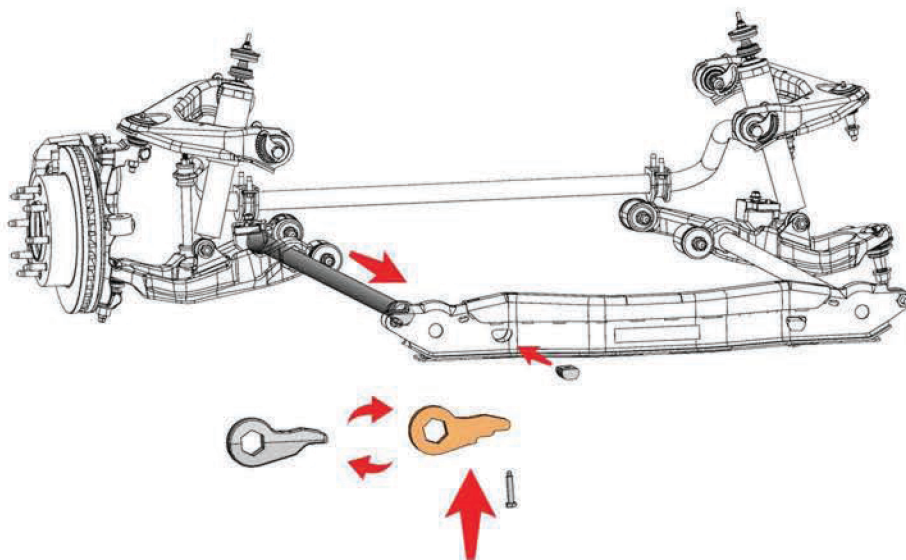

**Figure A**

Illustration is for reference only. Part dimensions will vary from kit to kit.

Installation Instructions continued on reverse





**TRAXDA**  
Lift Kits - Made in USA

**Toll free: 888-660-5892**  
**email: [info@traxda.com](mailto:info@traxda.com)**

**SAFETY WARNING!**  
Always use the correct tools, and wear safety goggles. We **STRONGLY** recommend installation by a licensed mechanic on a properly secured locking lift.

**TIRE FITMENT ADVICE**  
The best way to ensure proper tire fitment is to install the kit before purchasing your wheels and tires. Always test fit tires and wheels before purchasing.

**VEHICLE RIDE WARNING!**  
Trucks with lift or level kits installed have a higher center of gravity. Aggressive and sudden direction changes may cause a tip over.

## 101050 Installation Instructions continued

### STEP 3

Raise lower control arm with pit jack and re-connect upper ball joint and sway bar. Install shock spacer sleeve on shaft below lower washer and install shock. Set ride height with the torsion key adjusting bolt.

### STEP 4

Repeat steps 1 through 3 on the other side. Follow each step closely making sure to double check the torque on all fasteners.



	Left	Right
Caster (degrees)	2.0	2.5
Camber (degrees)	-.50	-.25
Toe	.03125 inch toe in	
Special Tools	none	

### Alignment Note:

**If this will be the first time the truck has been aligned, a camber kit may be needed.**